

Tipping Hoist Models

SPECIFICATION NOTES

- All specifications subject to change without notice. Gough Transport Solutions accepts no responsibility for any losses incurred from any such changes, including those that occur as a result of fabrication using dimensions shown.
- A tipper body will not meet Australian Standard AS1418.8, or Occupational Health & Safety regulations without a Cylinder Blocking System, or similar safety device, fitted.
- Tipping hoists are designed as a lifting device only, for longitudinal-axis loads. They must not be used as a structural member or be subject to side load.
- Allowable hydraulic-oil temperature range is -40°C to +80°C.
- Maximum duration of extension is 2 hours.
- A Series and B Series products are zinc plated. All other models are painted grey (RAL 7021). Both finishes conform to corresponding ISO 9227 neutral salt spray tests.
- Hoist capacity relates to the body weight plus the payload. This value, calculated at the rated working pressure, is an approximate indication of tipping capacity, to be used as the first criteria for hoist selection. Actual tipping capacity can only be determined by the tipper designer/manufacturer, and must consider all geometry of the tipper body and operating conditions.
- Rated working pressure 140 bar. Maximum working pressure 200 bar.
- Never exceed maximum pressure.
- Never exceed maximum hoist load.
- Weights shown include brackets.

UNDERBODY TIPPING HOIST

HIGH-TRUNNION TYPE

B SERIES

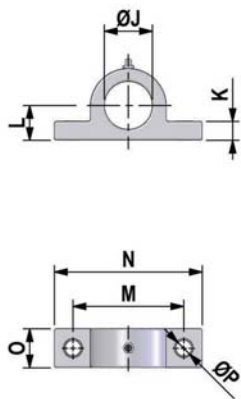

øJ	K	L	M	N	O	P
[mm]	[mm]	[mm]	[mm]	[mm]	[mm]	[mm]
45.5	18	33	105	140	37	15

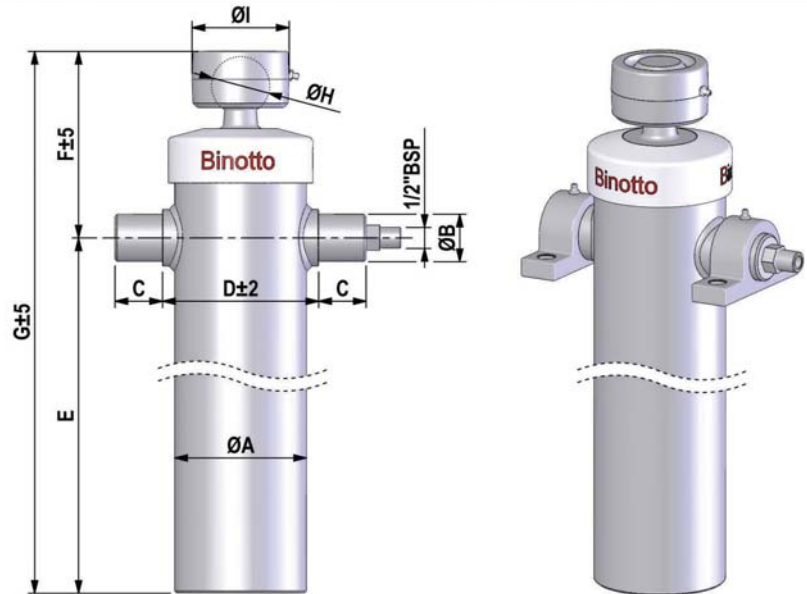

CODE	STAGES	STROKE [mm]	PIVOTS [48° mm]	CAPACITY [ton]	VOLUME [L]	WEIGHT [kg]	øA [mm]	øB [mm]	C [mm]	D [mm]	E [mm]	F [mm]	G [mm]	øH [mm]	øI [mm]
B095.3.0540	3	540	670	4	1.8	14	95	40	40	125	173	154	327	45	88
B095.4.0830	4	830	1030	2.5	2.3	15	95	40	40	125	199	155	354	45	88
B110.4.0825	4	825	1020	4.5	3.6	20	110	40	40	148	207	157	364	45	88
B125.4.1435	4	1435	1770	7	8.9	40	125	40	40	148	388	171	559	55	90
B125.4.1635	4	1635	2010	7	10	44	125	40	40	148	438	171	609	55	90
B125.4.1940	4	1940	2390	7	12	50	125	40	40	148	514	171	685	55	90
B125.5.1030	5	1030	1270	5	5.5	24	125	40	40	148	207	160	367	45	88
B125.5.1245	5	1245	1540	5	6.7	28	125	40	40	148	250	160	410	45	88
B125.5.1480	5	1480	1820	5	7.9	31	125	40	40	148	297	160	457	45	88
B125.5.2045	5	2045	2520	5	11	42	125	40	40	148	439	160	599	45	88
B125.5.2425	5	2425	2990	5	13	50	125	40	40	148	515	160	675	45	88
B125.6.1000	6	1000	1230	4	4.7	20	125	40	40	148	182	148	330	45	88
B145.5.1170	5	1170	1440	8	8.7	40	145	45	45	165	278	161	439	55	90
B145.5.2040	5	2040	2510	8	15	59	145	45	45	165	452	161	613	55	90
B145.5.2420	5	2420	2980	8	18	66	145	45	45	165	528	161	689	55	90
B145.6.1410	6	1410	1740	7	9.2	38	145	45	45	165	265	163	428	45	88
B145.6.1705	6	1705	2100	7	11	43	145	45	45	165	314	163	477	45	88
B145.6.2910	6	2910	3580	7	19	66	145	45	45	165	515	163	678	45	88